

DLHT

DOUBLE LEVER HAND TOOL

This professional-grade, high-quality tool features a built-in power transmission designed for effortless setting of larger-sized blind rivet nuts and rivet nut studs.

INSTALLATION SIZES: 1/4-20 TO 1/2-20 (M6 – M12)

DLHT (IMPERIAL TOOL) INCLUDES: 1/4-20, 5/16-18, 3/8-16, AND 1/2-13 SET UPS

DLHT (METRIC TOOL) INCLUDES: M6, M8, M10, AND M12 SET UPS

WEIGHT: 3.55 POUNDS (1.6 KG)

DIMENSIONS: FULLY EXTENDED – 20.5" LONG – 24" HANDLE SPAN

QUICK SETUP

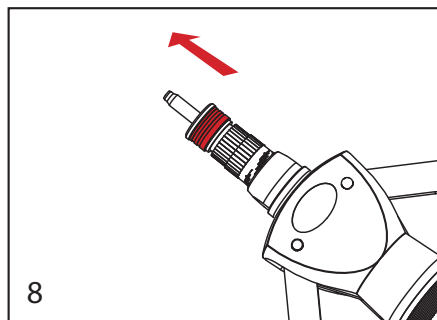
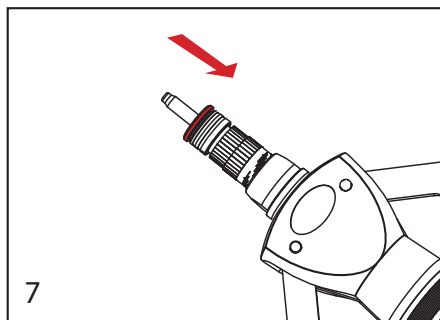
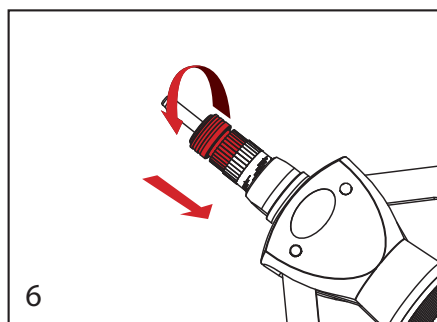
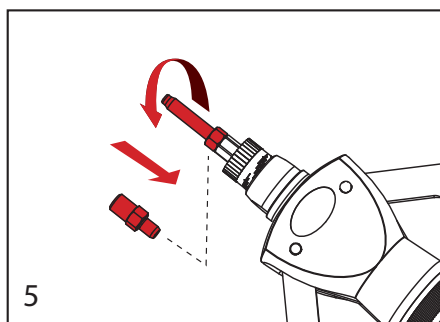
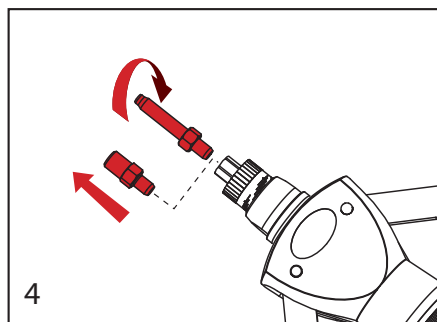
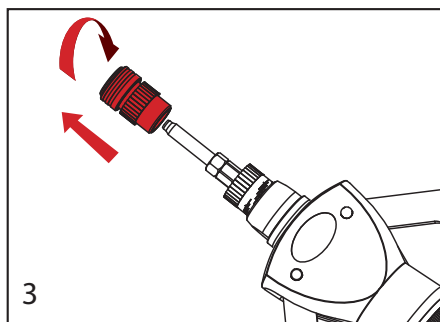
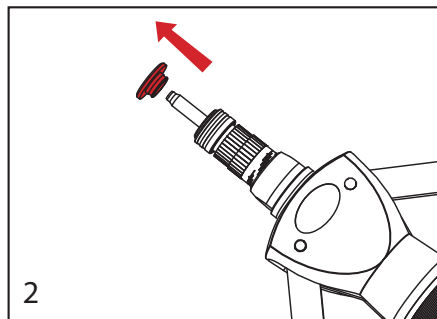
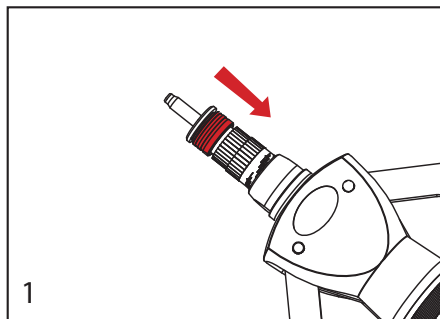
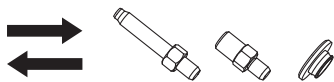

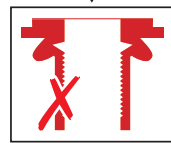
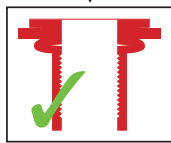
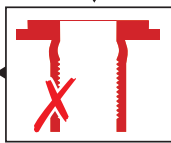
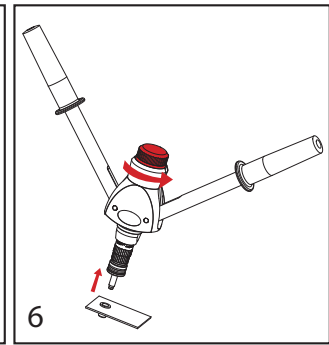
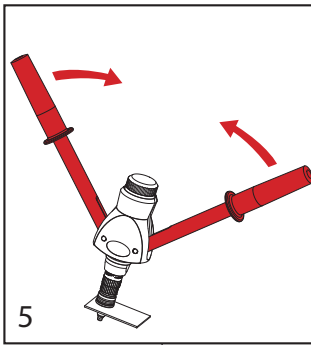
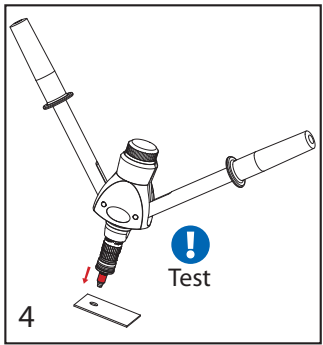
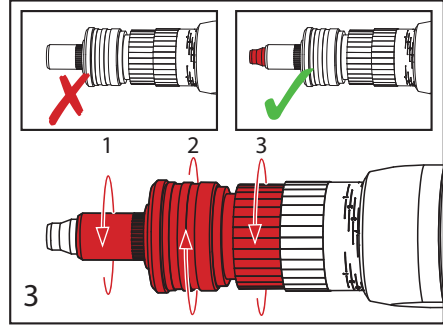
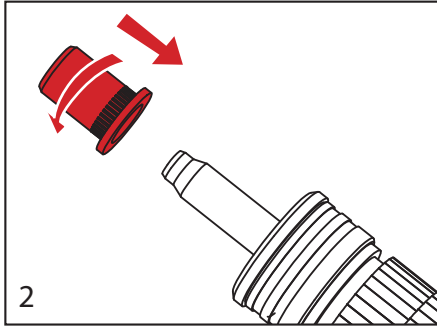
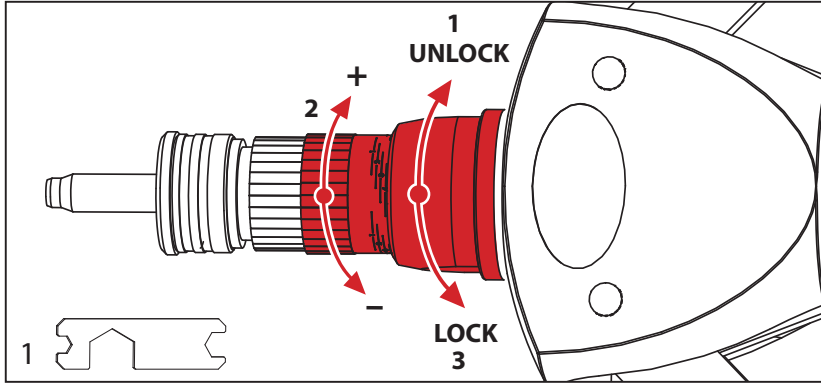

+

OK

-

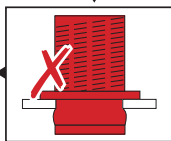
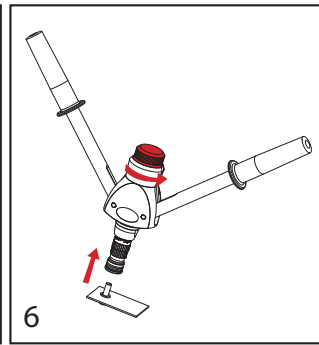
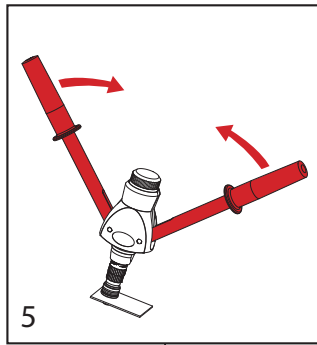
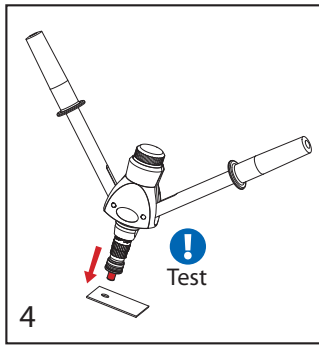
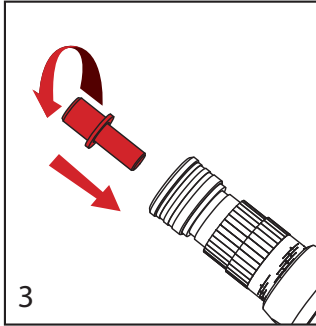
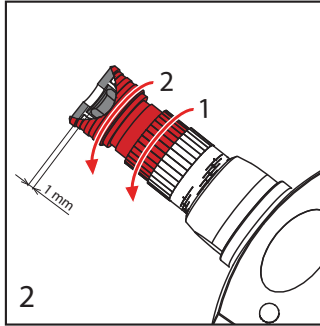
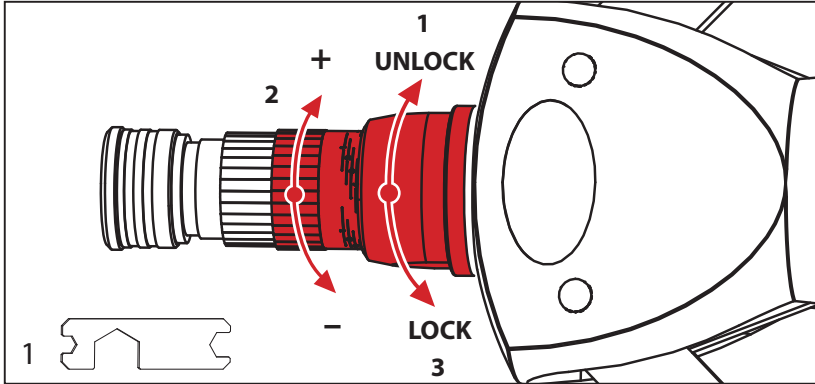

+

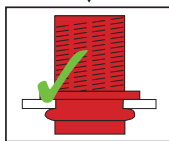

OK

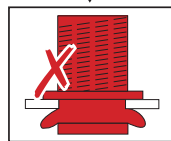

-

SETUP



1. Remove the nosepiece **(1)** from the tool.
2. Thread the shorter portion of the mandrel **(3)** into the silver threaded portion of the tool, align the flat surfaces.
3. Thread the nosepiece **(1)** over the mandrel **(3)** back onto the tool until it is securely fastened.
4. Snap the anvil **(2)** onto the front of the nosepiece **(1)**.

INSTALLATION SEQUENCE



1. Extend the handles **(5, 6)** as far as they will go while threading the specific rivet nut type onto the mandrel **(3)**.
2. Adjust the nosepiece **(1)** for the specific rivet nut type so that the rivet nut receives full thread engagement on the mandrel **(3)**.
3. Thread rivet nut fully onto tool, contacting anvil **(2)**.
4. Insert the rivet nut into the hole of your application while it is threaded onto the tool.
5. Grasp the handles **(5, 6)** & extend them until they stop.
6. While continuing to grasp the handles **(5, 6)** bring them back toward each other until they stop.
7. Stroke can be determined by the indicator lines **(7)** which are in mm.
8. Turn the rear assembly **(4)** counterclockwise & remove the tool from the application.

TOOL DIMENSIONS



SHEREX PART NUMBERS



THREAD SIZE	SHEREX HEAD SET PART NO. (includes Anvil & Mandrel)	SHEREX ANVIL PART NO.	SHEREX MANDREL PART NO.
1/4-20	MHS-2520	MA-2520	M-2520
1/4-28	MHS-2528	MA-2528	M-2528
5/16-18	MHS-3118	MA-3118	M-3118
5/16-24	MHS-3124	MA-3124	M-3124
3/8-16	MHS-3716	MA-3716	M-3716
3/8-24	MHS-3724	MA-3724	M-3724
1/2-13	MHS-5013	MA-5013	M-5013
1/2-20	MHS-5020	MA-5020	M-5020
M6	MHS-M6	MA-M6	M-M6
M8	MHS-M8	MA-M8	M-M8
M10	MHS-M10	MA-M10	M-M10
M12	MHS-M12	MA-M12	M-M12

FOR CUSTOMER SERVICE CALL 866.474.3739

**SHEREX FASTENING SOLUTIONS
LINE OF TOOLING**

HAND TOOLS



PNEUMATIC TOOLS



HYDRO-PNEUMATIC TOOLS



SHEREX.COM

400 Riverwalk Parkway, Suite 600
Tonawanda, NY 14150 USA
sherex.com | info@sherex.com
Toll-free: 866.474.3739

